

# Premium Booth 3mW x 5mD One side open

SD-C-15 - 3mW x 5mD x 3.5mH

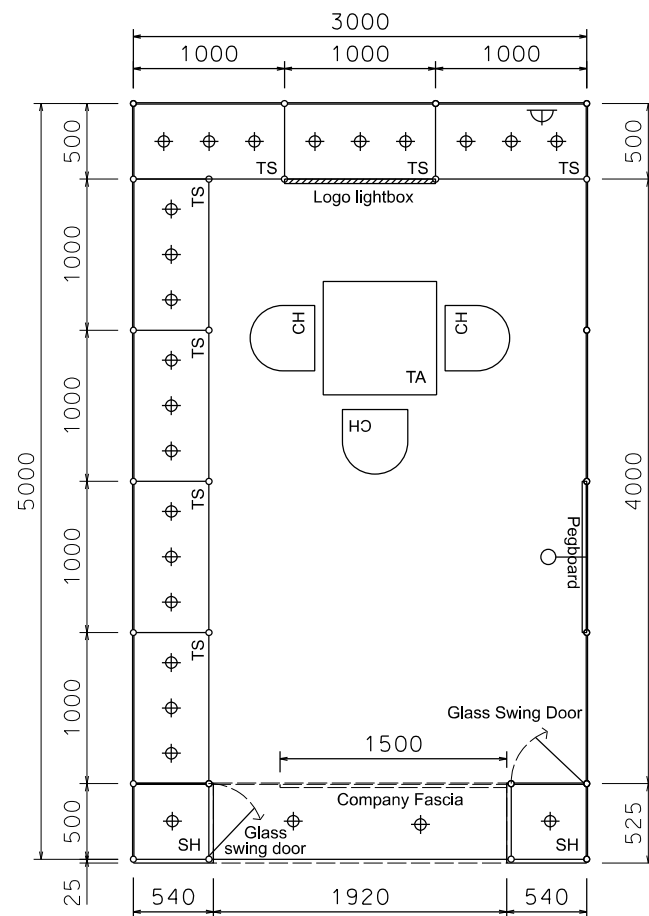

PLAN

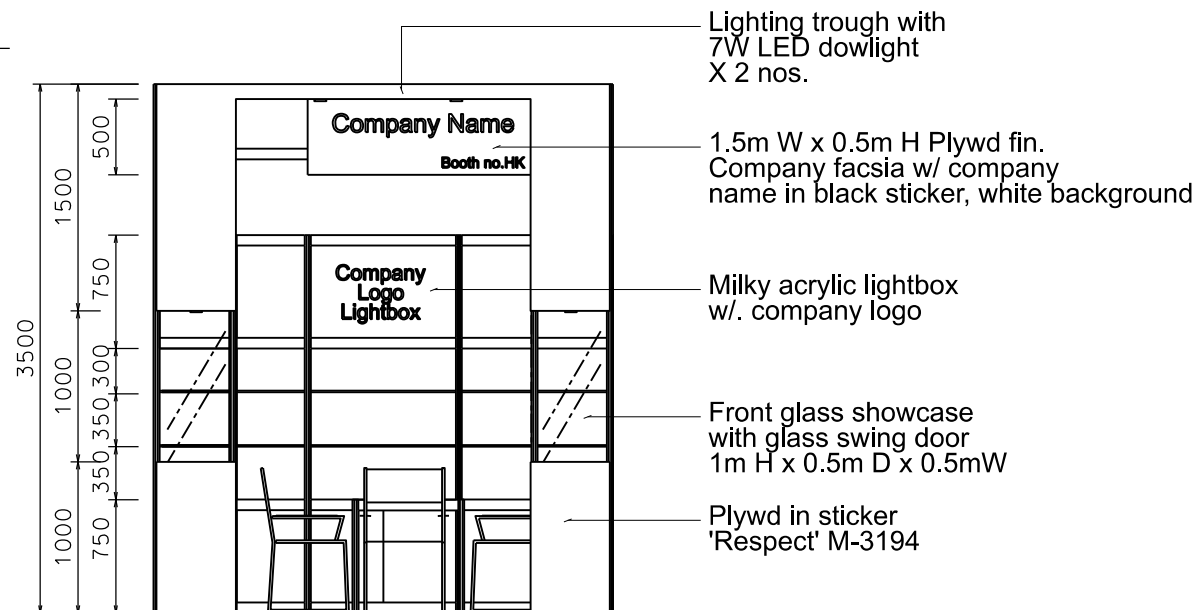

FRONT ELEVATION

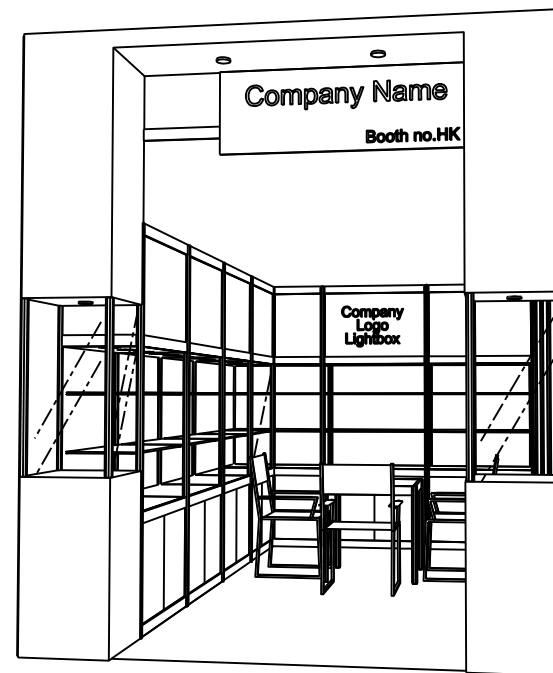

PERSPECTIVE N.T.S



COLOUR PERSPECTIVE N.T.S

BOOTH SPECIFICATION		QTY
	Tall showcase with 2 layer of glass shelf (with no door), 3x 7W LED downlights, with cabinet underneath	7
	Front showcase in sticker lamination finish with glass swing door w/ x1(7W) LED downlight (no glass shelf)	2
	Pegboard w/. 30 hooks (1mW x 2.5mH)	1
	Square meeting table (0.7m X0.7m x 0.75mH)	1
	Black leather chair	3
	Longarmed spotlight w/13 watt LED lamp (yellow)	1
	7W LED light (for fascia)	2
	800w Square pin power socket	1
	Company Logo Lightbox (1mL x 0.75mH)	1

FILE PATH - L:\Local Fair Premium Booth 2011\SD-Layouts(800w)\SD-C layout(800w)\SD-C-2dLayout(800w)-update.dgn



**NOTES** UNLESS OTHERWISE SPECIFIED ALL DIMENSIONS ARE IN MM.

.....  
 .....  
 .....

**REVISION**  
 12-05-2009  
 08-07-2009  
 14-09-2009  
 20-01-2010  
 22-01-2010  
 05-05-2015  
 08-01-2019

**DATE:** 08-01-2019  
**SCALE:** 1 : 50 (A3)  
**DRAWN BY:** ..  
**CHECKED BY:** .....

**TITLE**  
 Premium Booth SD-C-15

**PROJECT**  
 PREMIUM BOOTH 3m x 5m  
 DATE: 2009

**SHEET**  
 SD-C03