

Premium Booth 3mW x 5mD One side open

SD-A-15
3mW x 5mD x 3.5mH

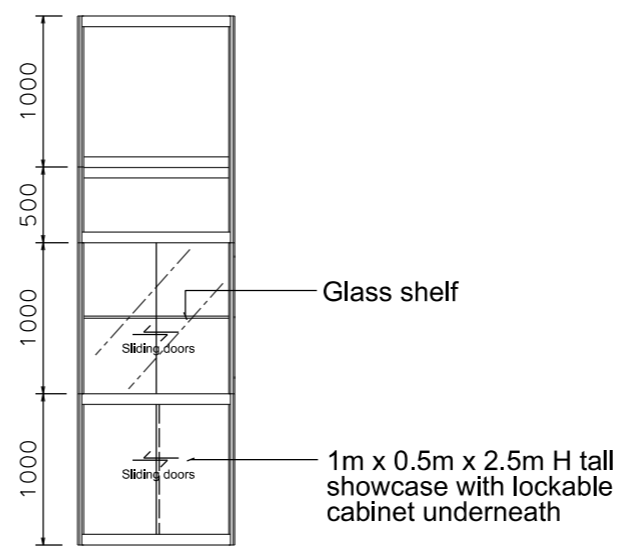
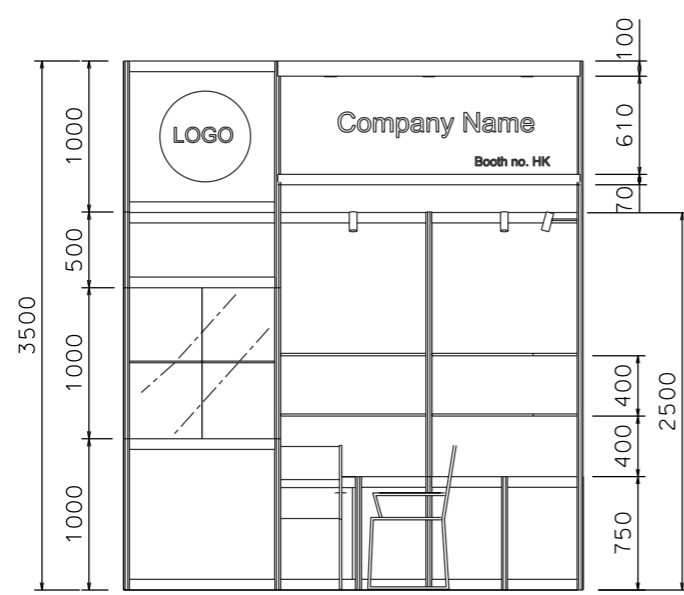
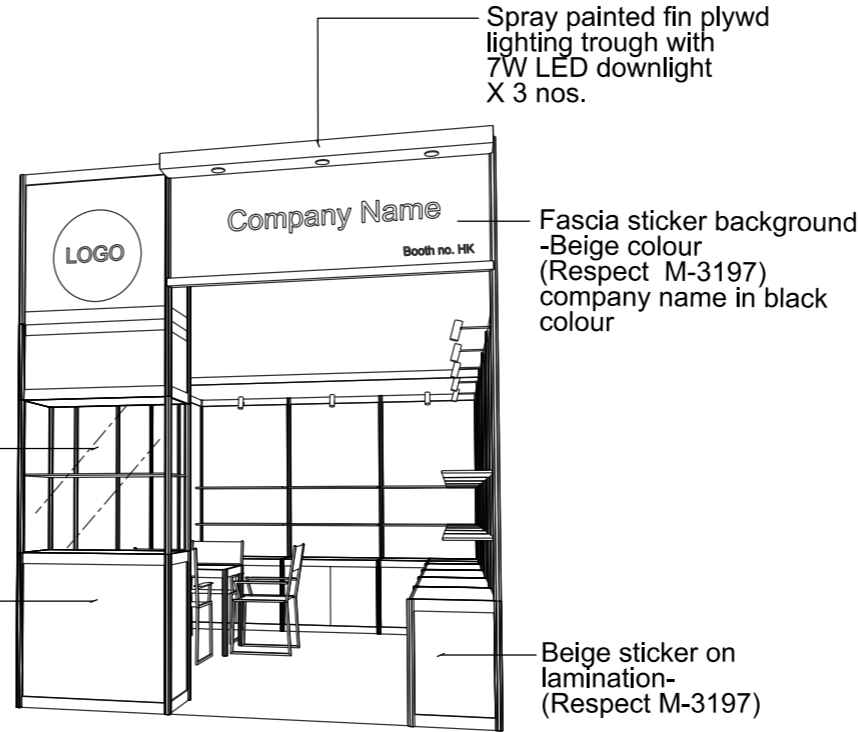
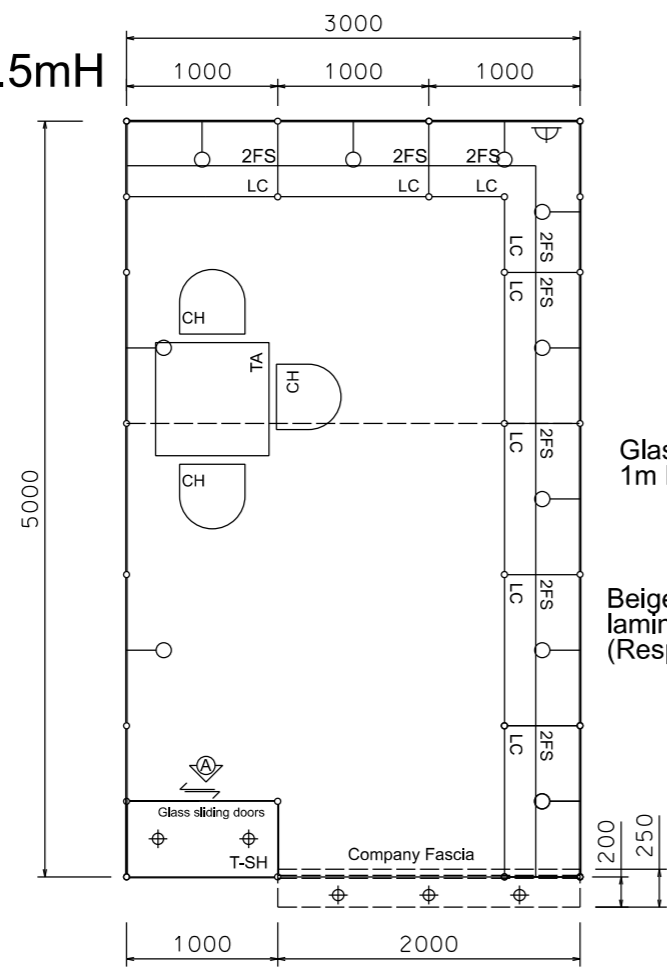

BOOTH SPECIFICATION		QTY
	Tall showcase in beige sticker lamination, 1 layer of glass shelf, 2x 7W LED downlights	1
	Lockable cabinet in beige sticker lamination (1mL x 0.5mD x 0.75mH)	7.5
	Wooden shelf (flat) (1mL x 0.3mD)	16
	Square meeting table (0.7m X0.7m x 0.75mH)	1
	Black leather chair	3
	13W LED Lamp Longarmed Spotlight (yellow)	10
	7W LED light (for fascia)	3
	800w Square pin power socket	1
	Company Logo	1

FILE PATH - L:\Local Fair Premium Booth 2011\SD-Layouts(800w)\SD-A layout(800w)\SD-A-Layout(800w).dgn



NOTES UNLESS OTHERWISE SPECIFIED ALL DIMENSIONS ARE IN MM.

.....

.....

.....

REVISION
26-11-08
31-12-2008
15-01-2009
09-02-2009
12-05-2009
18-05-2009
15-07-2009
08-01-2019

DATE:	08-01-2019
SCALE:	1 : 50 (A3)
DRAWN BY:	..
CHECKED BY:

TITLE
Premium Booth SD-A-15

PROJECT
PREMIUM BOOTH 3m x 5m
DATE: XXXXXXXX

SHEET
SD-A03