

Premium Booth 3mW x 3mD One side open

SD-E-9
3mW x 3mD x 3.5mH

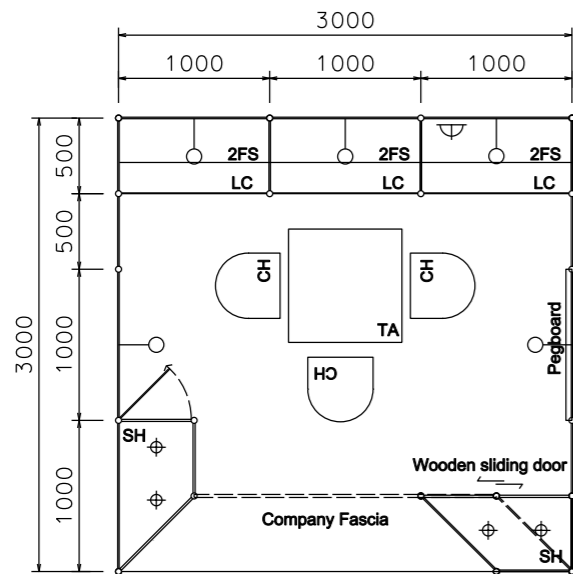

- Company Fascia
Panel in colour laminate stickers
-Respect M-3176)
-Respect M-3173)
-company name letters in white
- Panel in colour sticker lamination
-(Respect M-3176)
- Glass showcase with white wooden sliding door
(1000mmW x500mmD x2500mmH)
with 2x 50W halogen downlight)
- Glass showcase with white wooden swing door
(1000mmW x500mmD x2500mmH)
with 2x 50W halogen downlight)
- Plywd panel in colour sticker laminations
-(Respect M-3176)
-(Respect M-3173)



COLOUR PERSPECTIVE N.T.S

PLAN

PERSPECTIVE N.T.S

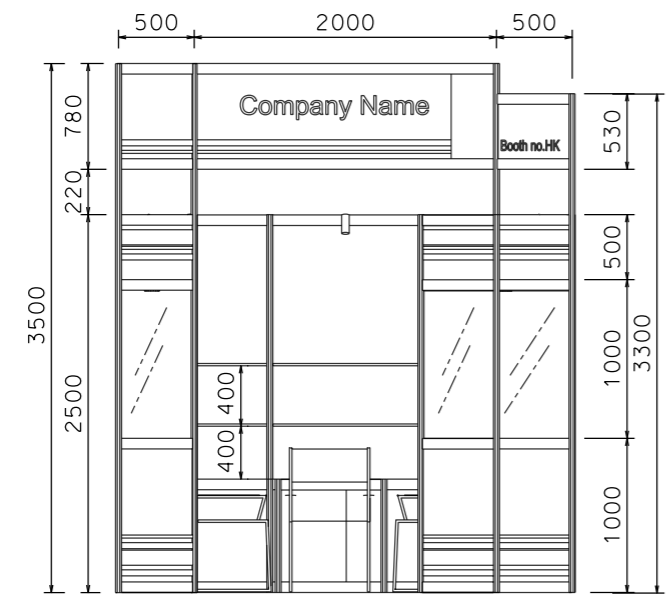

FRONT ELEVATION

BOOTH SPECIFICATION		QTY
	Front glass showcase in sticker lamination with white wooden swing door. 2 x (50W) halogen downlight (1m W x 0.5mD x 2.5m H)	1
	Front glass showcase in sticker lamination with white wooden sliding doors. 2 x (50W) halogen downlight (1m W x 0.5mD x 2.5m H)	1
	Lockable cabinet (1mL x 0.5mD x 0.75mH)	3
	Wooden shelf (flat) (1mL x 0.3mD)	6
	Pegboard with 30 hooks (1mW x 2.5mH)	1
	Square meeting table (0.7m X0.7m x 0.75mH)	1
	Black leather chair	3
	Longarmed spotlight w/23 watt energy saving lamp (yellow)	5
	800w Square pin power socket	1

FILE PATH - \$FILES



NOTES UNLESS OTHERWISE SPECIFIED ALL DIMENSIONS ARE IN MM.

.....

.....

.....

REVISION
05-01-2009
07-01-2009
15-01-2009
21-01-2009
12-05-2009
18-05-2009
15-07-2009
20-01-2010

DATE:	20-01-2010
SCALE:	1 : 50 (A3)
DRAWN BY:	..
CHECKED BY:

TITLE
Premium Booth SD-E-9

PROJECT
PREMIUM BOOTH
3m x 3m
DATE: XXXXXXXX

SHEET
SD-E01

Premium Booth 3mW x 3mD Right Corner booth

SD-E-9-R Cnr
3mW x 3mD x 3.5mH

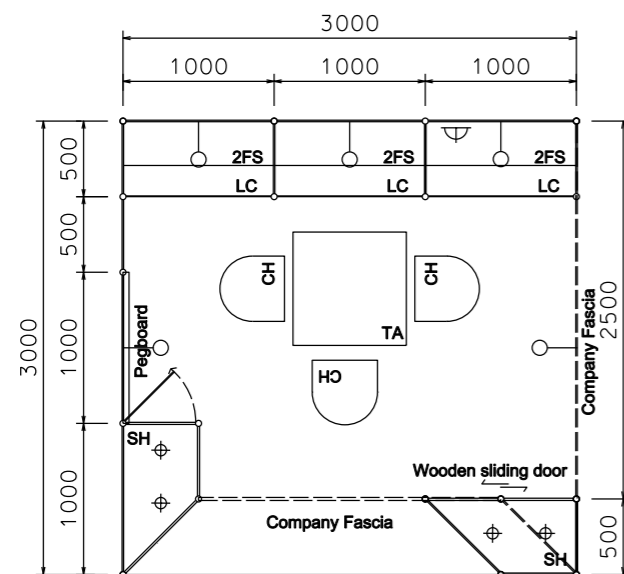

PLAN

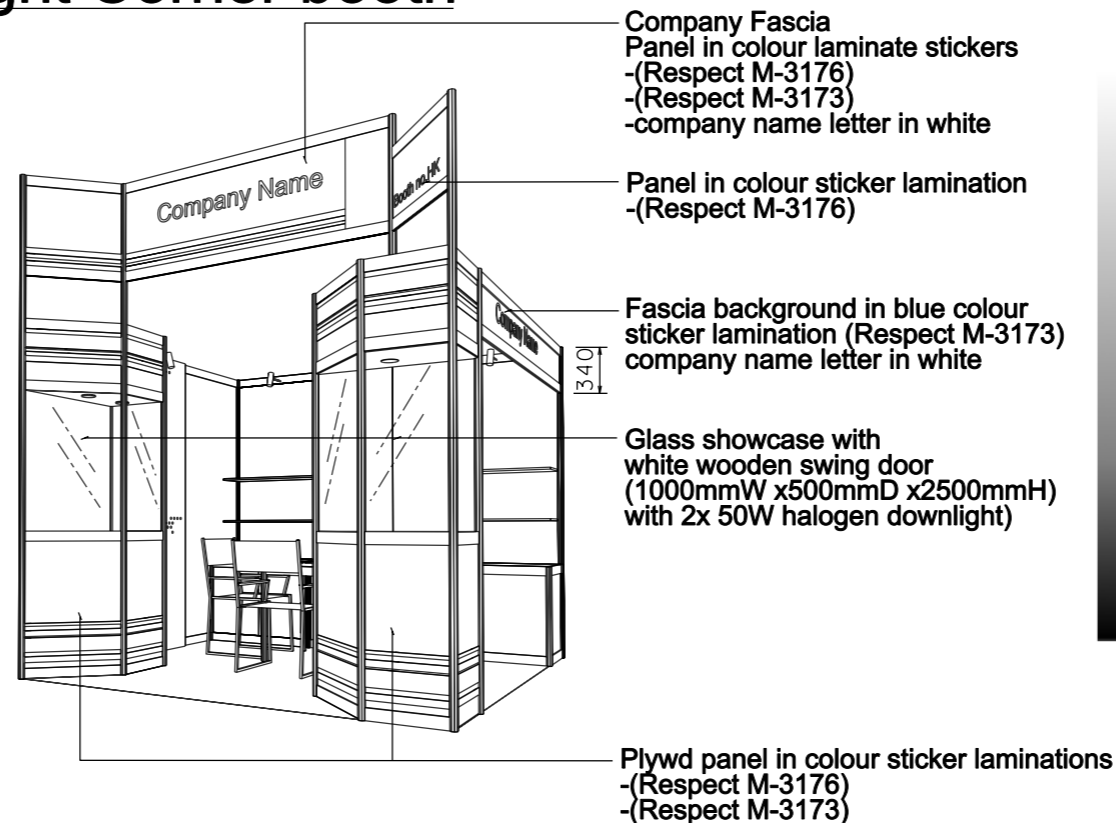

PERSPECTIVE N.T.S

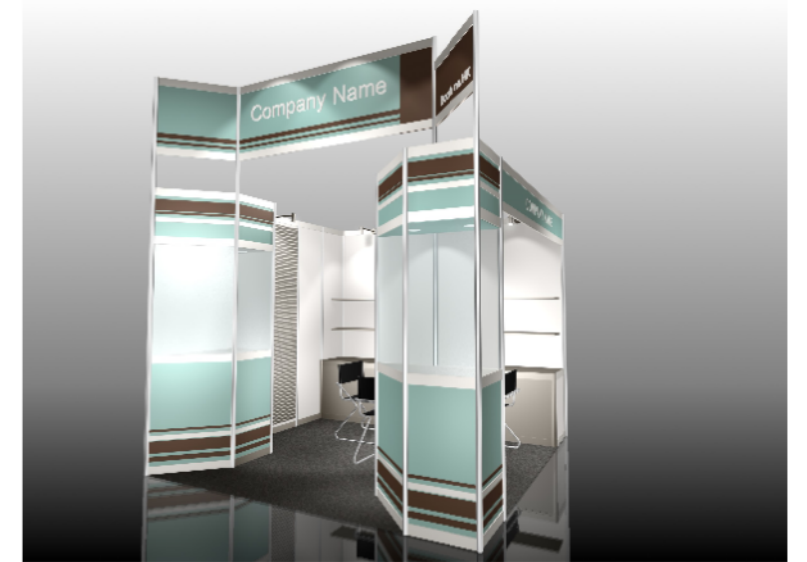

COLOUR PERSPECTIVE N.T.S

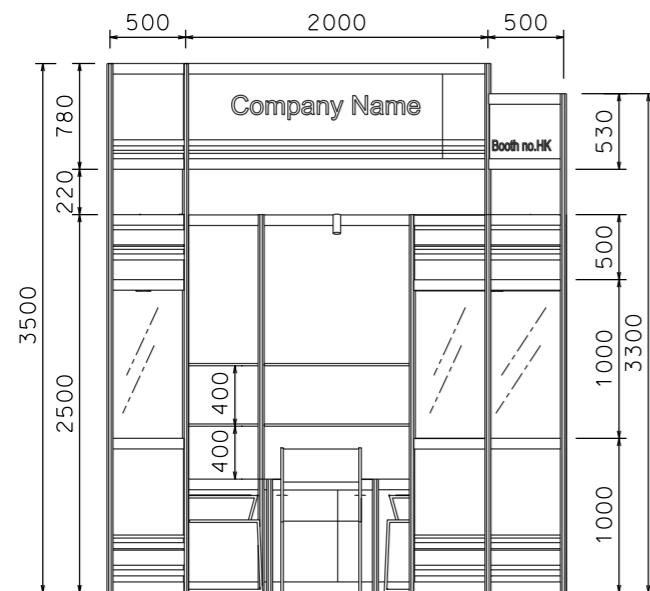

FRONT ELEVATION

BOOTH SPECIFICATION		QTY
	Front glass showcase in sticker lamination with white wooden swing door. 2 x (50W) halogen downlight (1m W x 0.5mD x 2.5m H)	1
	Front glass showcase in sticker lamination with white wooden sliding doors. 2 x (50W) halogen downlight (1m W x 0.5mD x 2.5m H)	1
	Lockable cabinet (1mL x 0.5mD x 0.75mH)	3
	Wooden shelf (flat) (1mL x 0.3mD)	6
	Pegboard with 30 hooks (1mW x 2.5mH)	1
	Square meeting table (0.7m X 0.7m x 0.75mH)	1
	Black leather chair	3
	Longarmed spotlight w/23 watt energy saving lamp (yellow)	5
	800w Square pin power socket	1

FILE PATH - \$FILES\$



NOTES UNLESS OTHERWISE SPECIFIED ALL DIMENSIONS ARE IN MM.

.....
.....
.....

.....
.....
.....

REVISION
20-05-2009 .
20-01-2010

DATE: 20-01-2010

SCALE: 1 : 50 (A3)

DRAWN BY: ..

CHECKED BY:

TITLE

Premium Booth
SD-E-9
R-Corner

PROJECT

PREMIUM BOOTH
3m x 3m
Corner

DATE: XXXXXXXX

SHEET

SD-E01a

Premium Booth 3mW x 3mD Left Corner booth

SD-E-9-L Cnr
3mW x 3mD x 3.5mH

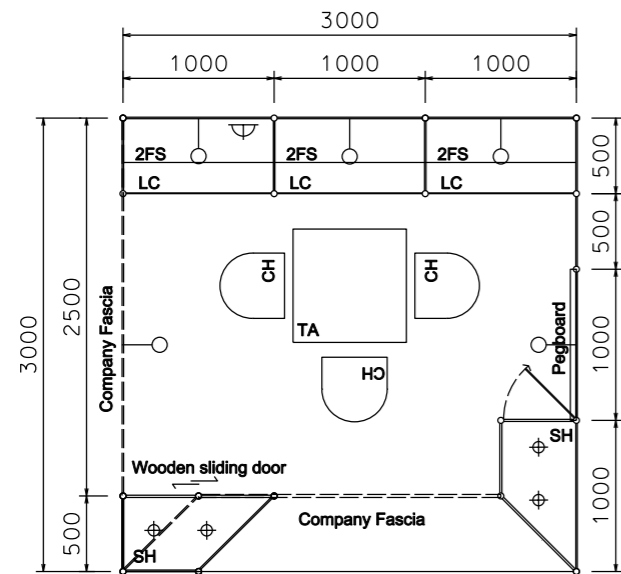

PLAN

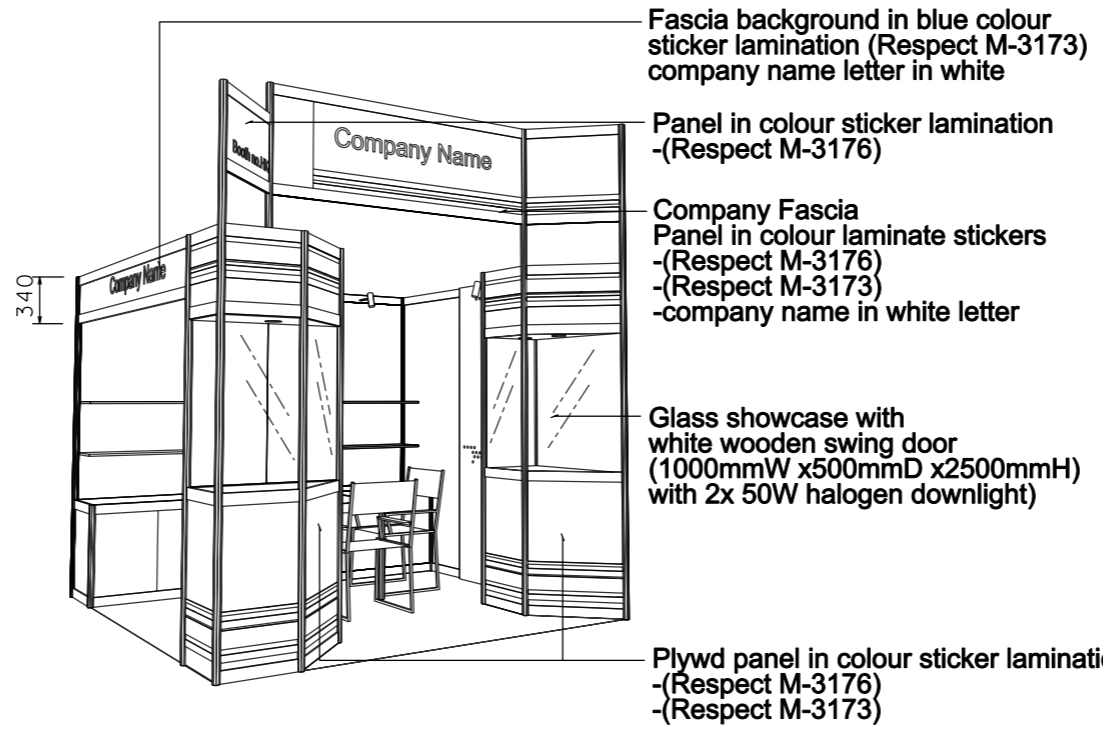

PERSPECTIVE N.T.S.

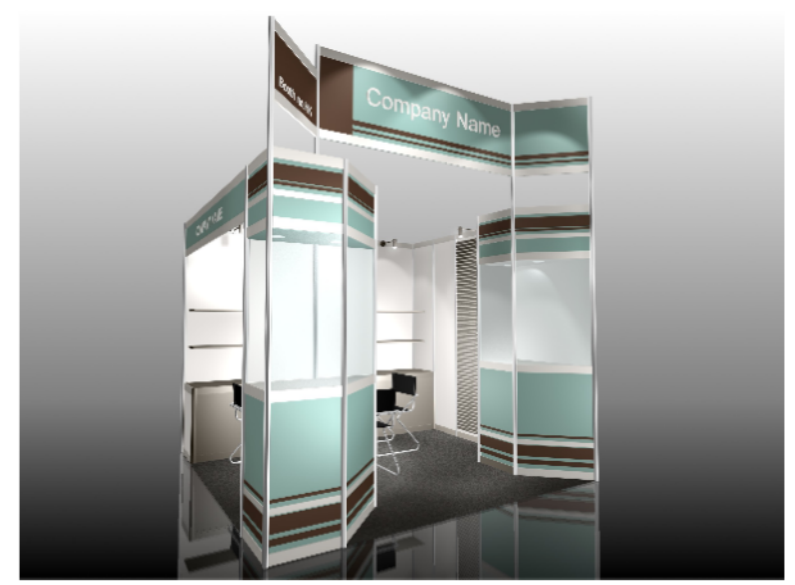

COLOUR PERSPECTIVE N.T.S.

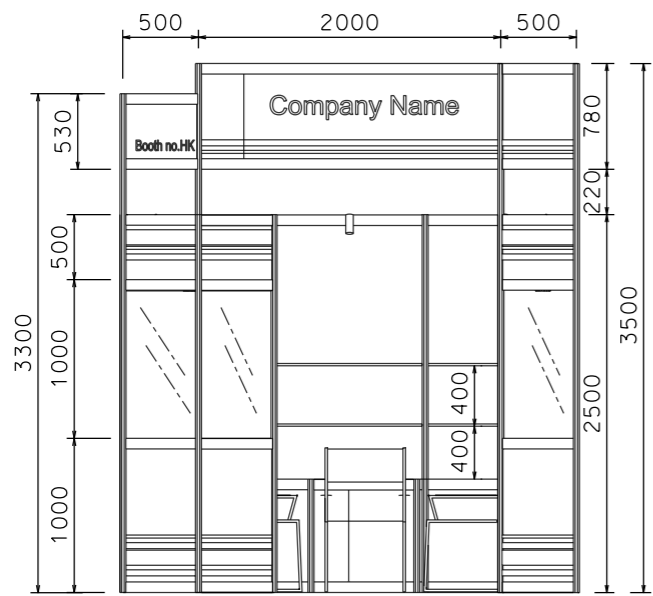

FRONT ELEVATION

BOOTH SPECIFICATION		QTY
	Front glass showcase in sticker lamination with white wooden swing door. 2 x (50W) halogen downlight (1m W x 0.5mD x 2.5m H)	1
	Front glass showcase in sticker lamination with white wooden sliding doors. 2 x (50W) halogen downlight (1m W x 0.5mD x 2.5m H)	1
	Lockable cabinet (1mL x 0.5mD x 0.75mH)	3
	Wooden shelf (flat) (1mL x 0.3mD)	6
	Pegboard with 30 hooks (1mW x 2.5mH)	1
	Square meeting table (0.7m X 0.7m x 0.75mH)	1
	Black leather chair	3
	Longarmed spotlight w/23 watt energy saving lamp (yellow)	5
	800w Square pin power socket	1

FILE PATH - \$FILEL\$



NOTES UNLESS OTHERWISE SPECIFIED ALL DIMENSIONS ARE IN MM.

.....

.....

.....

REVISION
20-05-2009 .
20-01-2010

DATE: 20-01-2010

SCALE: 1 : 50 (A3)

DRAWN BY: ..

CHECKED BY:

TITLE

Premium Booth
SD-E-9
L-Corner

PROJECT

PREMIUM BOOTH
3m x 3m
Corner

DATE: XXXXXXXX

SHEET

SD-E01b

Premium Booth 3mW x 5mD One side open

SD-E-15 - 3mW x 5mD x 3.5mH

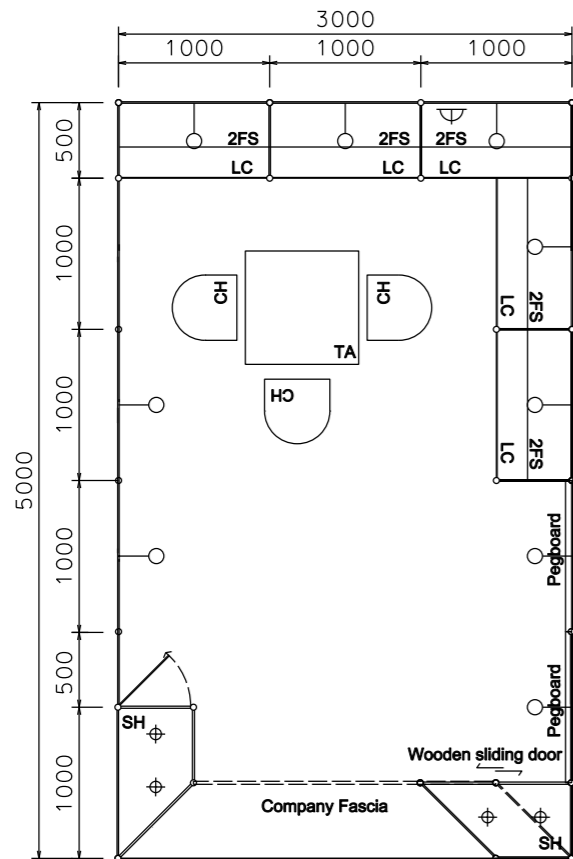

PLAN

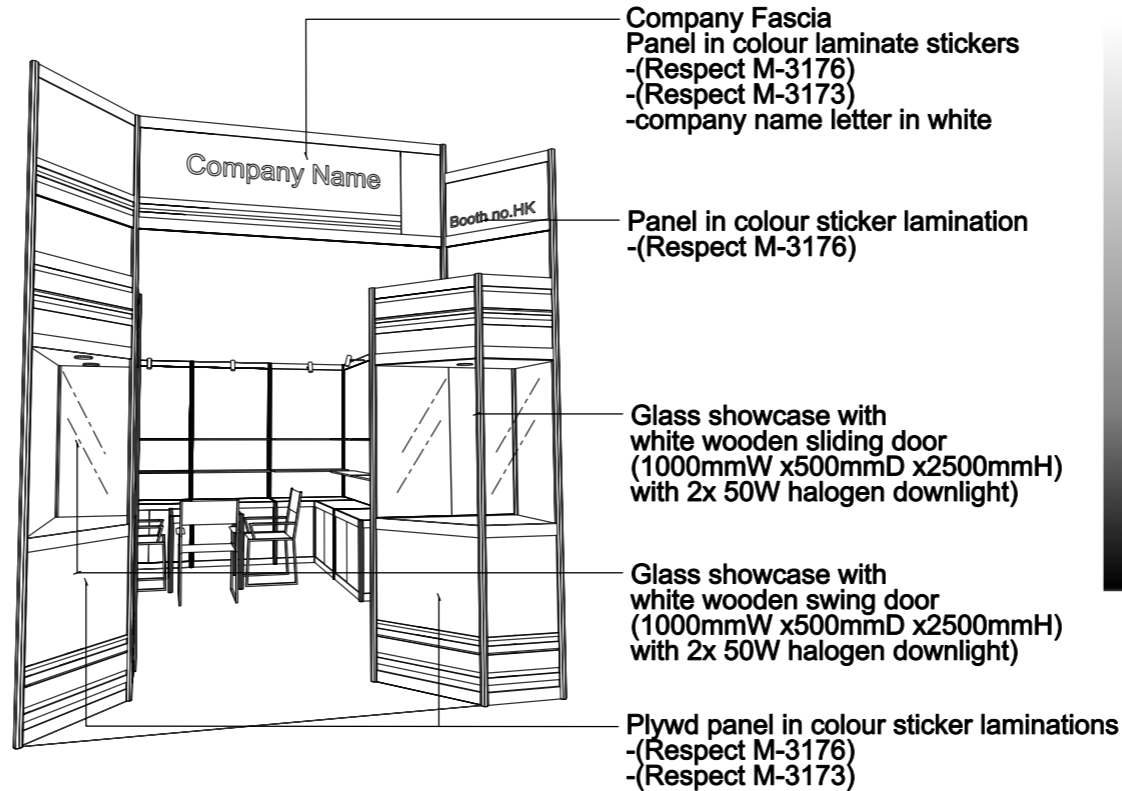

PERSPECTIVE N.T.S.



COLOUR PERSPECTIVE N.T.S.

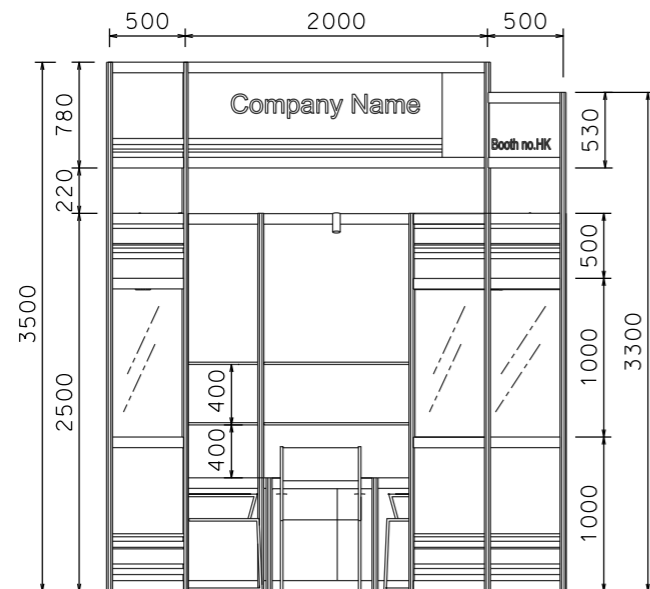

FRONT ELEVATION

BOOTH SPECIFICATION		QTY
	Front glass showcase in sticker lamination with white wooden swing door. 2 x (50W) halogen downlight (1m W x 0.5mD x 2.5m H)	1
	Front glass showcase in sticker lamination with white wooden sliding doors. 2 x (50W) halogen downlight (1m W x 0.5mD x 2.5m H)	1
	Lockable cabinet (1mL x 0.5mD x 0.75mH)	5
	Wooden shelf (flat) (1mL x 0.3mD)	10
	Pegboard with 30 hooks (1mW x 2.5mH)	2
	Square meeting table (0.7m X0.7m x 0.75mH)	1
	Black leather chair	3
	Longarmed spotlight w/23 watt energy saving lamp (yellow)	9
	800w Square pin power socket	1

FILE PATH - \$FILES



NOTES UNLESS OTHERWISE SPECIFIED ALL DIMENSIONS ARE IN MM.

.....
.....
.....

.....
.....
.....

REVISION
05-01-2009
07-01-2009
15-01-2009
21-01-2009
09-02-2009
12-05-2009
18-05-2009
15-07-2009
21-07-2009
20-01-2010

DATE: 20-01-2010
SCALE: 1 : 50 (A3)
DRAWN BY: ..
CHECKED BY:

TITLE
Premium Booth SD-E-15

PROJECT
PREMIUM BOOTH 3m x 5m
DATE: XXXXXXXX

SHEET
SD-E03

Premium Booth 3mW x 5mD Right Corner Booth

SD-E-15-R_Cnr - 3mW x 5mD x 3.5mH

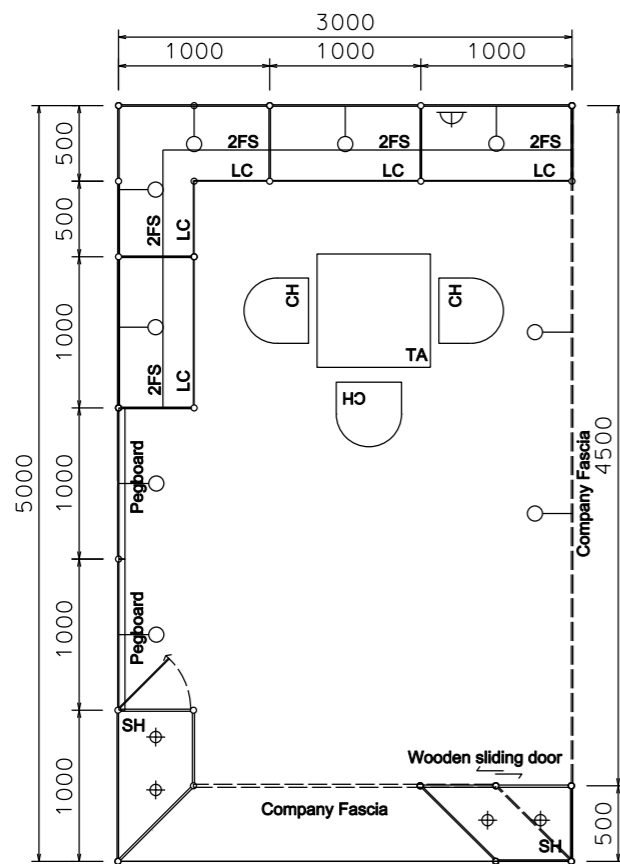

PLAN

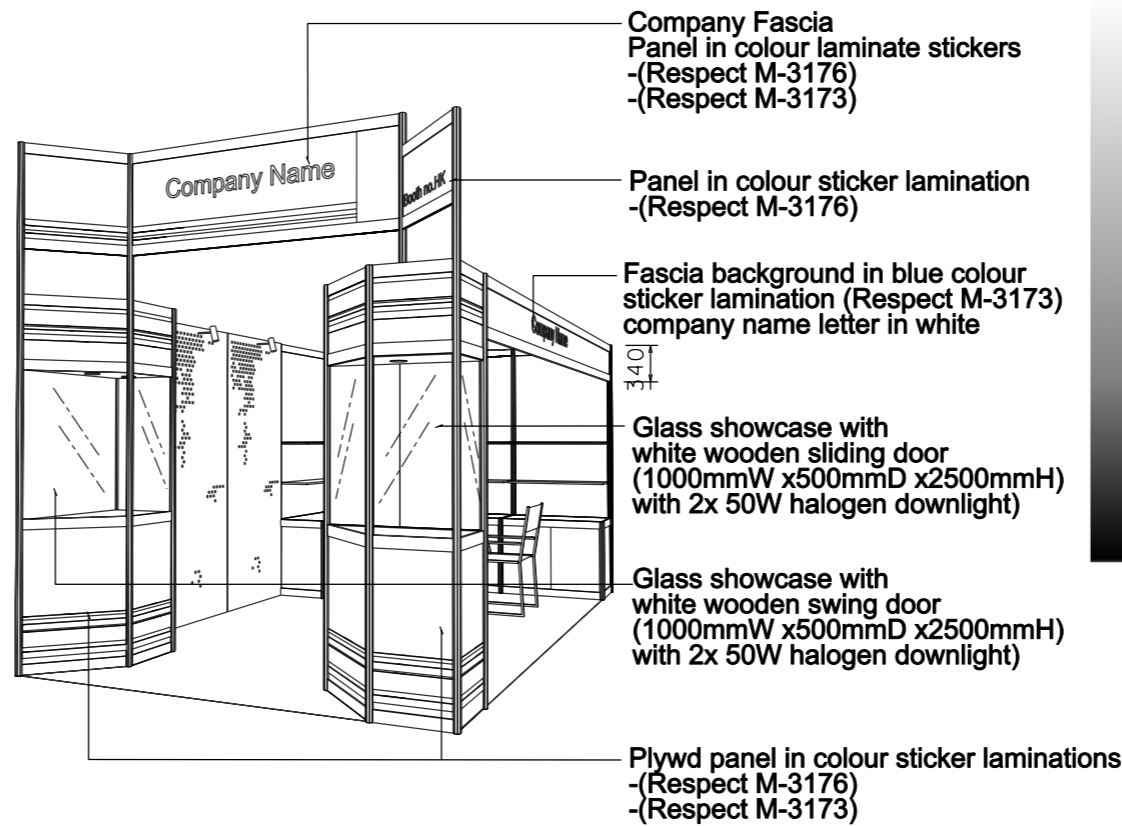

PERSPECTIVE N.T.S.

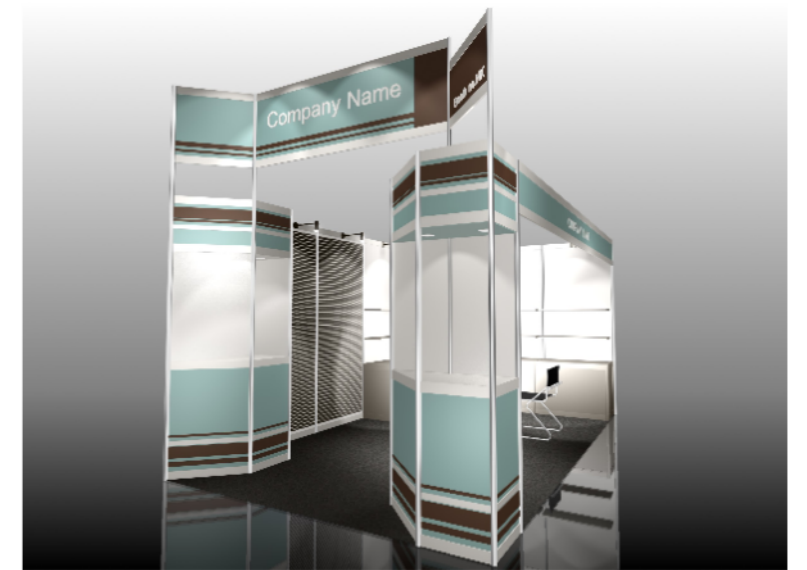

COLOUR PERSPECTIVE N.T.S.

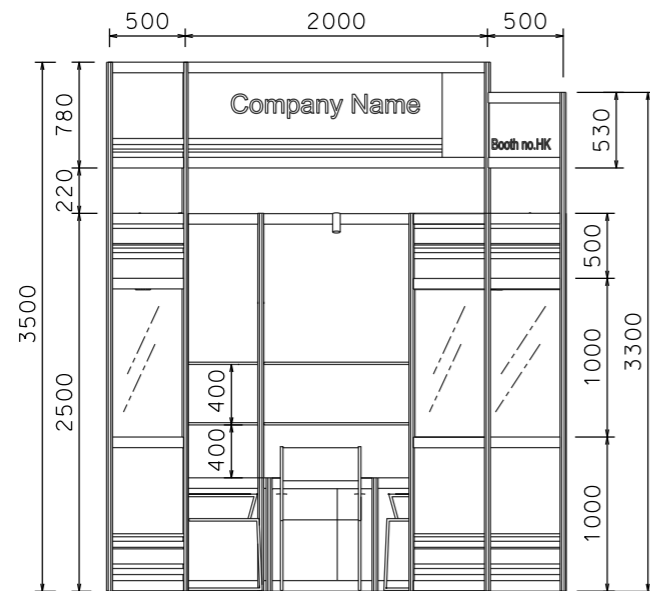

FRONT ELEVATION

BOOTH SPECIFICATION		QTY
	Front glass showcase in sticker lamination with white wooden swing door. 2 x (50W) halogen downlight (1m W x 0.5mD x 2.5m H)	1
	Front glass showcase in sticker lamination with white wooden sliding doors. 2 x (50W) halogen downlight (1m W x 0.5mD x 2.5m H)	1
	Lockable cabinet (1mL x 0.5mD x 0.75mH)	4.5
	Wooden shelf (flat) (1mL x 0.3mD)	10
	Pegboard with 30 hooks (1mW x 2.5mH)	2
	Square meeting table (0.7m X0.7m x 0.75mH)	1
	Black leather chair	3
	Longarmed spotlight w/23 watt energy saving lamp (yellow)	9
	800w Square pin power socket	1

FILE PATH - \$FILES



NOTES UNLESS OTHERWISE SPECIFIED ALL DIMENSIONS ARE IN MM.

.....

REVISION
 20-05-2009
 16-07-2009
 21-07-2009
 20-01-2010

DATE: 20-01-2010
 SCALE: 1 : 50 (A3)
 DRAWN BY: ..
 CHECKED BY:

TITLE
 Premium Booth
 SD-E-15
 R-Corner

PROJECT
 PREMIUM BOOTH
 3m x 5m
 Corner
 DATE: XXXXXXXX

SHEET
 SD-E03a

Premium Booth 3mW x 5mD Left Corner Booth

SD-E-15-L_Cnr - 3mW x 5mD x 3.5mH

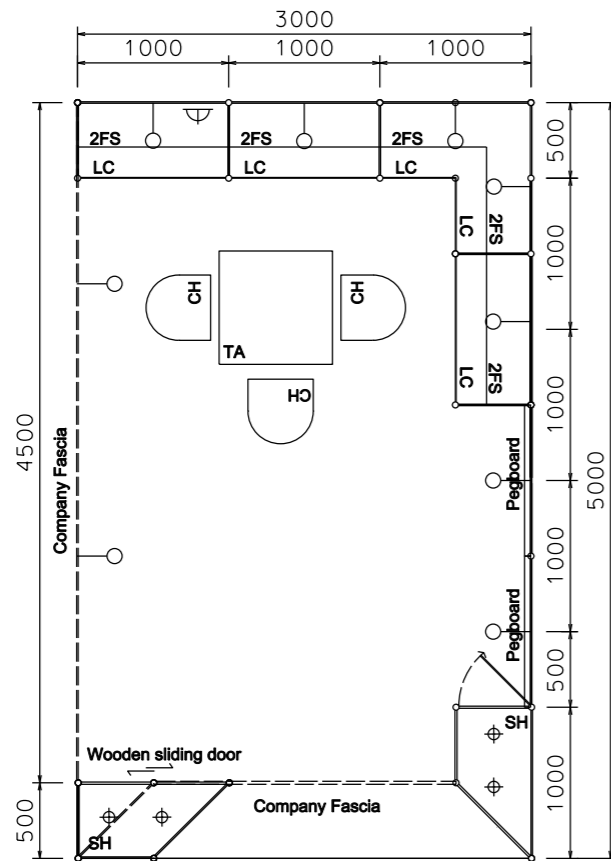

PLAN

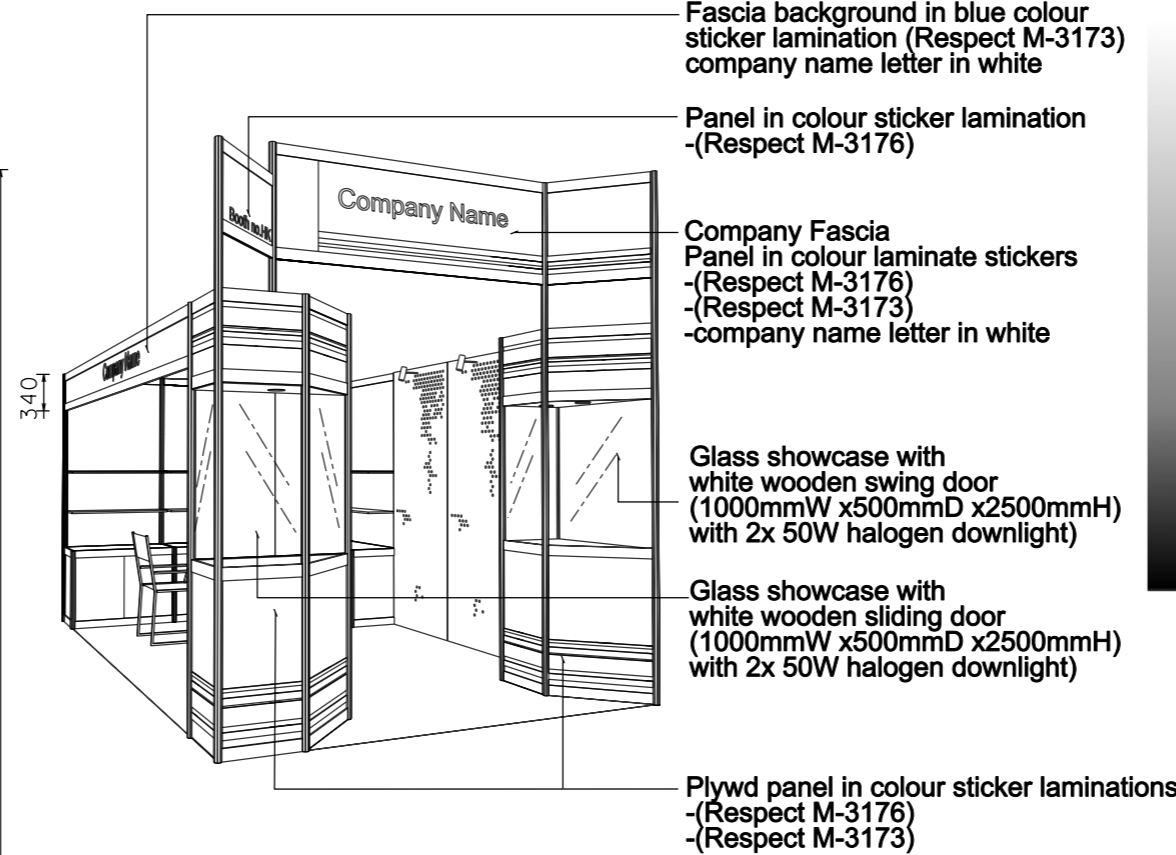

PERSPECTIVE N.T.S.

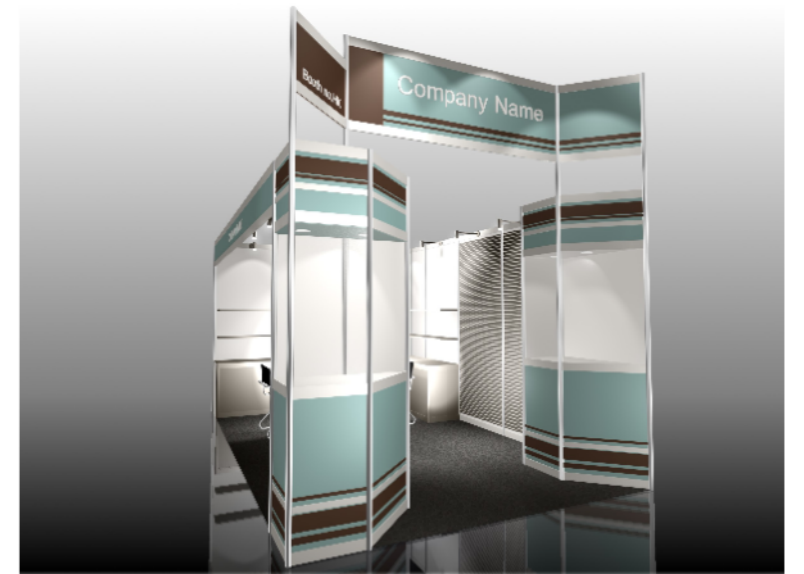

COLOUR PERSPECTIVE N.T.S.

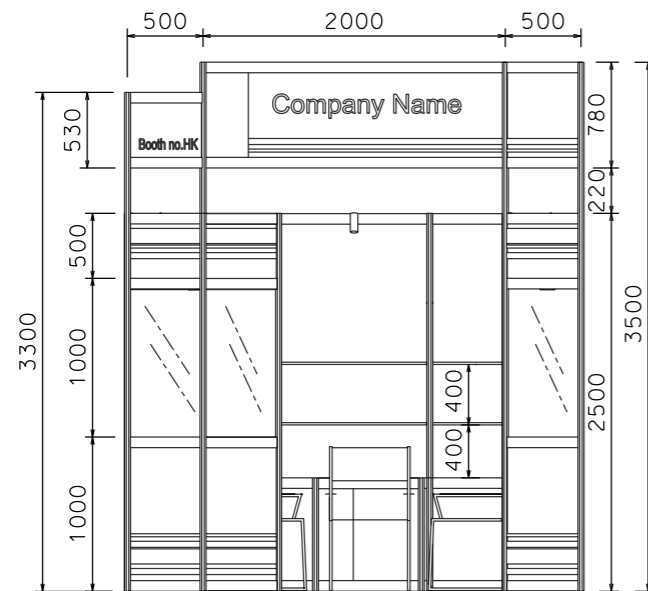

FRONT ELEVATION

BOOTH SPECIFICATION		QTY
	Front glass showcase in sticker lamination with white wooden swing door. 2 x (50W) halogen downlight (1m W x 0.5mD x 2.5m H)	1
	Front glass showcase in sticker lamination with white wooden sliding doors. 2 x (50W) halogen downlight (1m W x 0.5mD x 2.5m H)	1
	Lockable cabinet (1mL x 0.5mD x 0.75mH)	4.5
	Wooden shelf (flat) (1mL x 0.3mD)	10
	Pegboard with 30 hooks (1mW x 2.5mH)	2
	Square meeting table (0.7m X0.7m x 0.75mH)	1
	Black leather chair	3
	Longarmed spotlight w/23 watt energy saving lamp (yellow)	9
	800w Square pin power socket	1

FILE PATH - \$FILES



NOTES UNLESS OTHERWISE SPECIFIED ALL DIMENSIONS ARE IN MM.

.....

REVISION
 20-05-2009 .
 16-07-2009
 20-01-2010

DATE: 20-01-2010
 SCALE: 1 : 50 (A3)
 DRAWN BY: ..
 CHECKED BY:

TITLE
 Premium Booth
 SD-E-15
 L-Corner

PROJECT
 PREMIUM BOOTH
 3m x 5m
 Corner
 DATE: XXXXXXXX

SHEET
 SD-E03b