

# Premium Booth 3mW x 3mD Left side Corner Booth

SD-A-9-L Cnr  
3mW x 3mD x 3.5mH

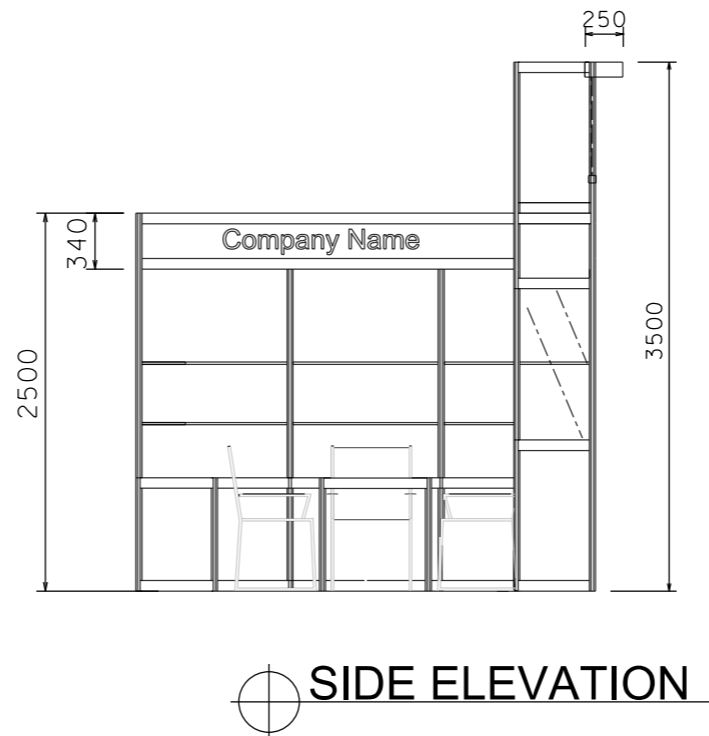
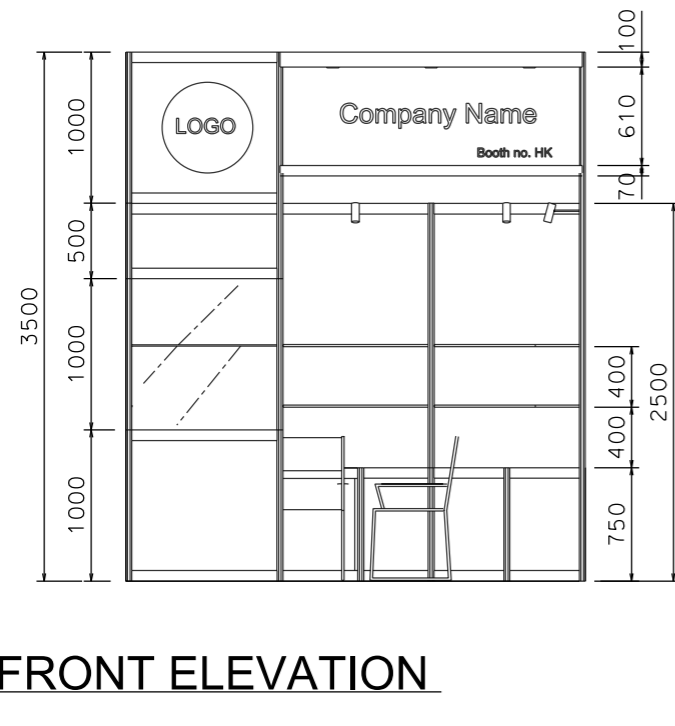
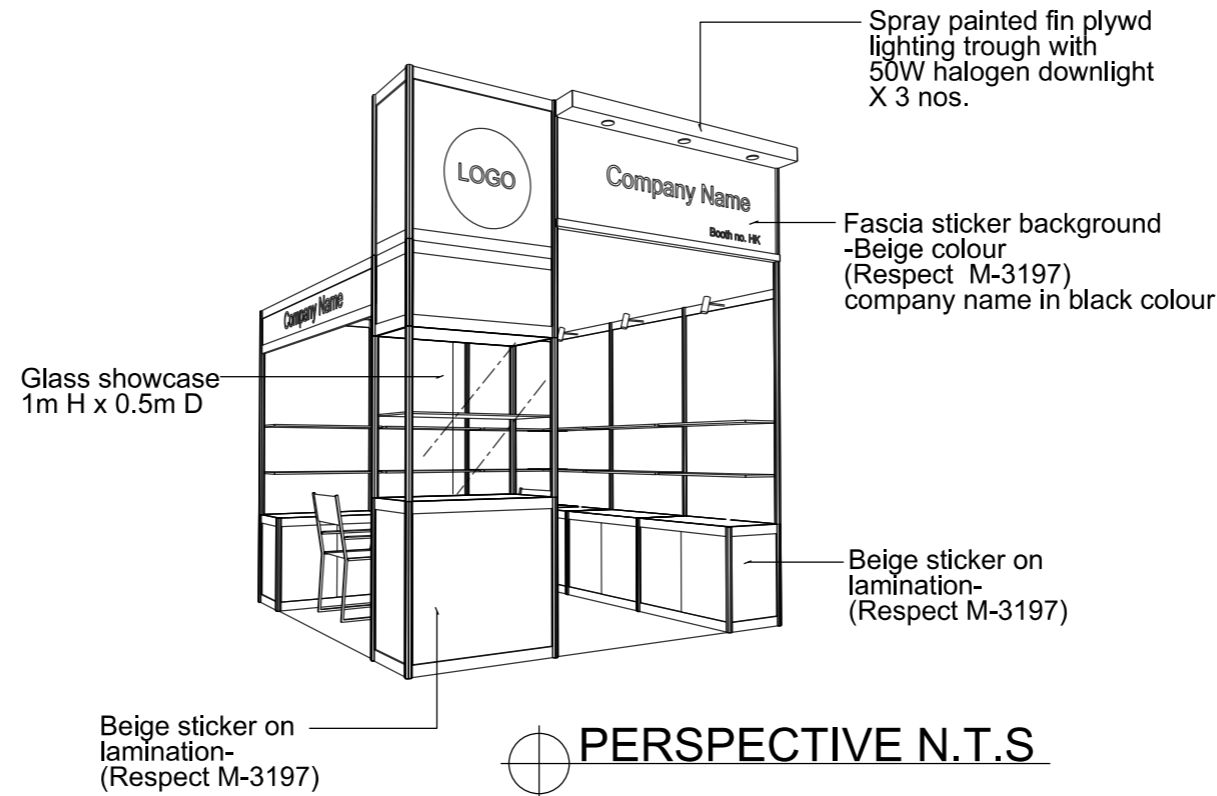
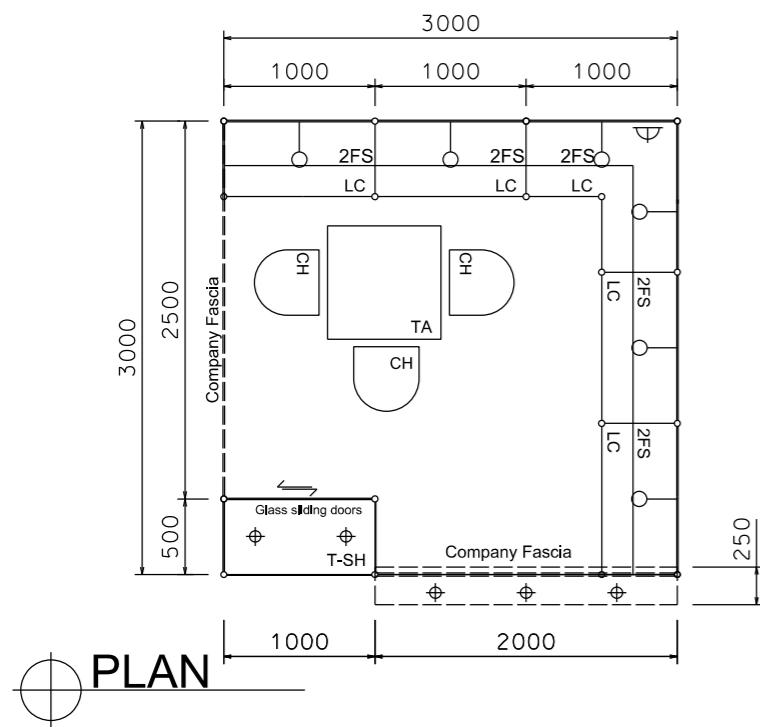

BOOTH SPECIFICATION		QTY
	Tall showcase in beige sticker lamination, 1 layer of glass shelf, 2x 50W halogen downlights	1
	Lockable cabinet in beige sticker lamination (1mL x 0.5mD x 0.75mH)	5.5
	Wooden shelf (flat) (1mL x 0.3mD)	12
	Square meeting table (0.7m X0.7m x 0.75mH)	1
	Black leather chair	3
	Longarmed spotlight w/23 watt energy saving lamp (yellow)	6
	50W Halogen light (for fascia)	3
	800w Square pin power socket	1
	Company Logo	1

FILE PATH - L:\Local Fair Premium Booth 2011\SD-Layouts(800w)\SD-A-Layout(800w).dgn



**NOTES** UNLESS OTHERWISE SPECIFIED ALL DIMENSIONS ARE IN MM.

.....  
.....  
.....

REVISION  
26-11-08  
15-12-08  
31-12-2008  
15-01-2009  
09-02-2009  
18-05-2009  
15-07-2009  
21-01-2010  
05-05-2015

DATE: 21-01-2010  
SCALE: 1 : 50 (A3)  
DRAWN BY: ..  
CHECKED BY: .....

**TITLE**  
Premium Booth  
SD-A-9-L  
Corner

**PROJECT**  
PREMIUM BOOTH  
3m x 3m Corner  
DATE: XXXXXXXX

SHEET  
SD-A01a